

C2C CUBE 213

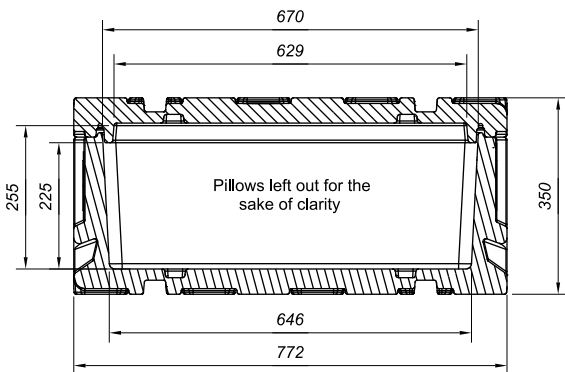

C2C Cube

Connecting cleanrooms.

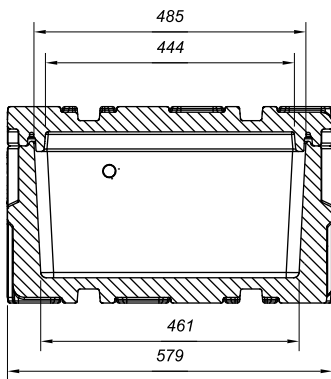

Cube specifications

Item number	4022.474.9960
Materials used	PELD, Fluorelastomer, Stainless steel
	<ul style="list-style-type: none"> • ISO class 5
	<ul style="list-style-type: none"> • Tested and released according to ISTA & GID
	<ul style="list-style-type: none"> • Equipped with RFID tags
	<ul style="list-style-type: none"> • Cleanable label surface
	<ul style="list-style-type: none"> • Fastening holes inside
	<ul style="list-style-type: none"> • Hoisting belts and straps inside CE certified
	<ul style="list-style-type: none"> • Pillows of cleanroom fabric filled with LRPU foam
External dimensions	772 x 579 x 350 mm
Internal dimensions	629 x 444 x 255 mm
Net weight	24 kg

Content specifications

Max sensitivity	30 G on product
Target size product	500 x 400 x 120 mm
Max part size	615 x 420 x 150 mm
Pillow size	655 x 460 x 80 mm
Max part weight	25 kg*

Transport packaging

	<ul style="list-style-type: none"> • Cube packed in double antistatic LDPE bags
	<ul style="list-style-type: none"> • Hoisting belts around the cube
	<ul style="list-style-type: none"> • Packed cube inside corrugated carton
	<ul style="list-style-type: none"> • Corrugated carton on a pallet
Total weight	28 kg
Transport size	800 x 600 x 380 mm**

*Higher weights possible at different G **Without pallet